

# SENTINEL™ PRODUCTS CATALOG

## SENTINEL VACUUM CONTROLLERS



The dairy industry's best vacuum control for 38 years, SENTINEL continues to provide excellence for milking systems of any size. In today's competitive dairy environment, count on SENTINEL for reliable superiority.

### Sentinel Mark II Vacuum Controller

- Sensitive to 0.1" Hg change
- Adjustment range 10" - 15" Hg
- Minimum flow while operating: 1 CFM ASME
- Finish: ABS and Lexan plastics
- Adjustment knob
- 2" male NPT mounting
- Size: 6" diameter x 11¼" high
- Filters: a. Top dome filter, submicron (LJE Part# 406-22) b. Main filter, sponge type (LJE Part# 406-21)
- Maximum capacity: 150 CFM ASME at 15" Hg
- Direct Sensing
- Weight: 1¼ lbs.
- PEACEKEEPER 462-200: Available noise suppressor with added filtration

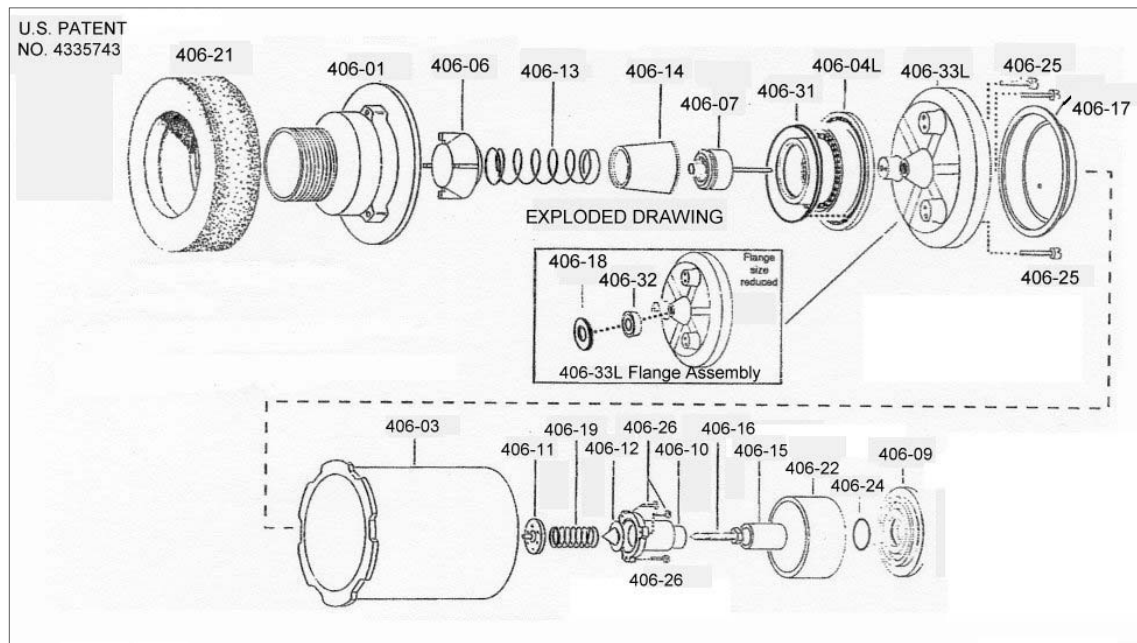

## L. J. ENGINEERING, INC.

18192 Gothard Street, Huntington Beach, CA 92648 USA  
Phone: (714) 848-8001 • In USA: 800-635-6413  
Fax: (714) 848-0973 Email: info@ljengineering.com

[www.sentinelproducts.com](http://www.sentinelproducts.com)

# SENTINEL™ PRODUCTS CATALOG

## Sentinel Mark II Vacuum Controller PARTS

Part#	Part Description
406-01	Outlet Body
406-03	Dome
406-04L	Flow Ring
406-06	Plug
406-07	Poppet Assembly
406-09	Filter Cap
406-10	Adjuster Housing
406-11	Dome Diaphragm
406-12	Wobble Plate
406-13	Closing Spring
406-14	Rolling Seal
406-15	Adjusting Knob
406-16	Adjusting Screw
406-17	Main Diaphragm

Part#	Part Description
406-18	Retaining Washer
406-19	Adjustment Spring
406-21	Main Filter
406-22	Dome Filter
406-24	"O" Ring
406-25	Flange Screw (3 each)
406-26	Adjuster Housing Screw (3 each)
406-31	Outlet Seal
406-32	Rod Seal
406-33L	Flange Assembly
406-334L	Flange & Flow Ring Set
PMM-M2	Parts & Maintenance Manual for the Mark II

### Sentinel Model 100 Vacuum Controller

- Sensitive to 0.1" Hg change
- Adjustment range 8" – 15" Hg
- Reaction time to change: 50 milliseconds or less
- Finish: Hard anodized aluminum for maximum durability and corrosion resistance
- Adjustment screw (with special wrench to restrict unauthorized tampering).
- 1½" female NPT mounting
- Size: 5" diameter x 12¾" high
- Filters: a. Top dome filter, submicron (LJE Part# 348-33) b. Main filter, standard paper cartridge type (LJE Part# AP-107)
- Maximum capacity: 150 CFM ASME at 15" Hg
- Direct Sensing
- Weight: 4 lbs.
- Nominal Air Pass-by: 10 CFM ASME
- PEACEKEEPER 462-100: Available noise suppressor with added filtration

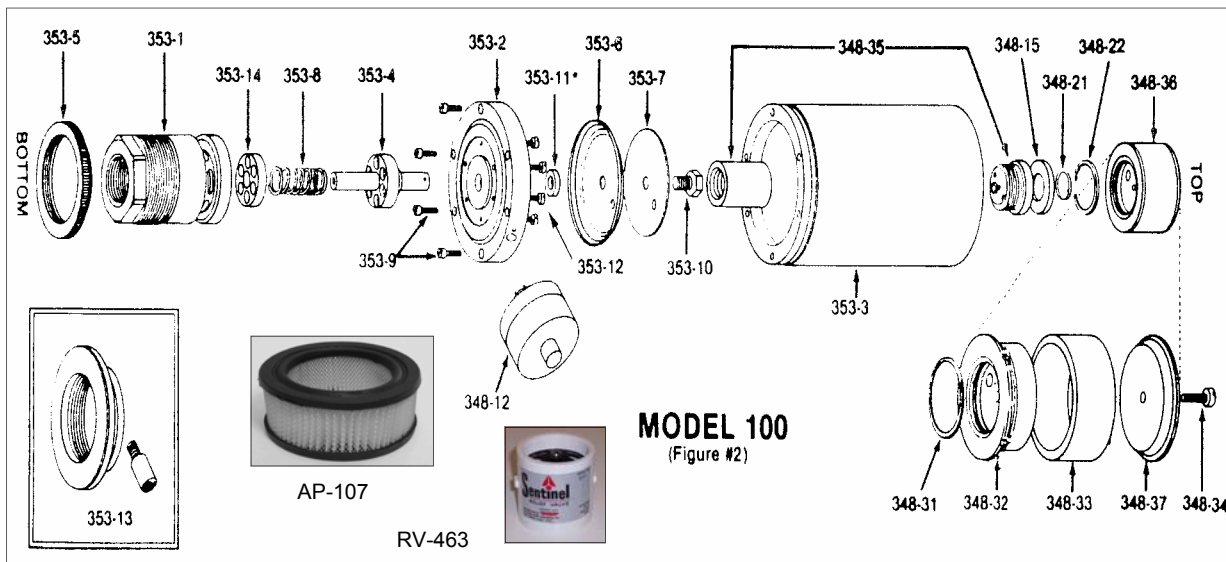

# SENTINEL™ PRODUCTS CATALOG

## Sentinel Model 100 Vacuum Controller PARTS

Part#	Part Description
353-01	Body
353-02	Flange
353-03	Dome
353-04	Poppet Assembly
353-05	Filter Retaining Ring
353-06	Diaphragm
353-07	Diaphragm Back-up Plate
353-08	Spring
353-09	Dome Screws (10-32 x 3/4)
353-13	Large Filter Adapter
353-14	Poppet Guide
RV-463	Small Relief Valve (2" NPT fitting)
AP-107	Main Paper Filter
PMM-VC	Parts & Maintenance Manual Model 100/350/500

Part#	Part Description
348-12	Air Filter Gauge
348-15	Top Felt Filter
348-21	Small Top Snap Ring
348-22	Large Top Snap Ring
348-31	Top Dome Filter O-Ring
348-32	Filter Cart. Holder-Bottom
348-33	Filter Replacement Cartridge
348-34	Top Filter Holding Screw (10-32 x 3/4)
348-35	Aneroid Complete
348-35 C	Aneroid Cap Only
348-35 B	Bellows Assembly
348-36	Top Dome Filter Complete
348-37	Filter Cart. Holder-Top

### Sentinel Model 350 Vacuum Controller

- Sensitive to 0.1" Hg change
- Adjustment range 8" - 15" Hg
- Reaction time to change: 50 milliseconds or less
- Hard anodized aluminum for maximum durability and corrosion resistance.
- Adjustment screw (with special wrench to restrict unauthorized tampering).
- 3" female NPT mounting
- Size: 7" diameter x 13¼" high
- Filters: a. Top dome filter, submicron (LJE Part# 348-33) b. Main filter, standard paper cartridge type (LJE Part# AP-58)
- Mounting: Quick-disconnect stainless steel clamp
- Maximum capacity: 350 CFM ASME at 15" Hg
- Direct Sensing
- Weight: 10 lbs.
- Nominal Air Pass-by: 15 CFM ASME
- PEACEKEEPER 462-350: Available noise suppressor with added filtration

### Sentinel Model 500 Vacuum Controller

- Sensitive to 0.1" Hg change
- Adjustment range 8" - 15" Hg
- Reaction time to change: 50 milliseconds or less
- Hard anodized aluminum for maximum durability and corrosion resistance.
- Adjustment screw (with special wrench to restrict unauthorized tampering).
- 3" female NPT mounting
- Size: 7" diameter x 13¼" high
- Filters: a. Top dome filter, submicron (LJE Part# 348-33) b. Main filter, standard paper cartridge type (LJE Part# AP-58)
- Mounting: Quick-disconnect stainless steel clamp
- Maximum capacity: 500 CFM ASME at 15" Hg
- Direct Sensing
- Weight: 10 lbs.
- Nominal Air Pass-by: 25 CFM ASME
- PEACEKEEPER 462-350: Available noise suppressor with added filtration

# SENTINEL™ PRODUCTS CATALOG

## Sentinel Model 350/500 Vacuum Controller PARTS

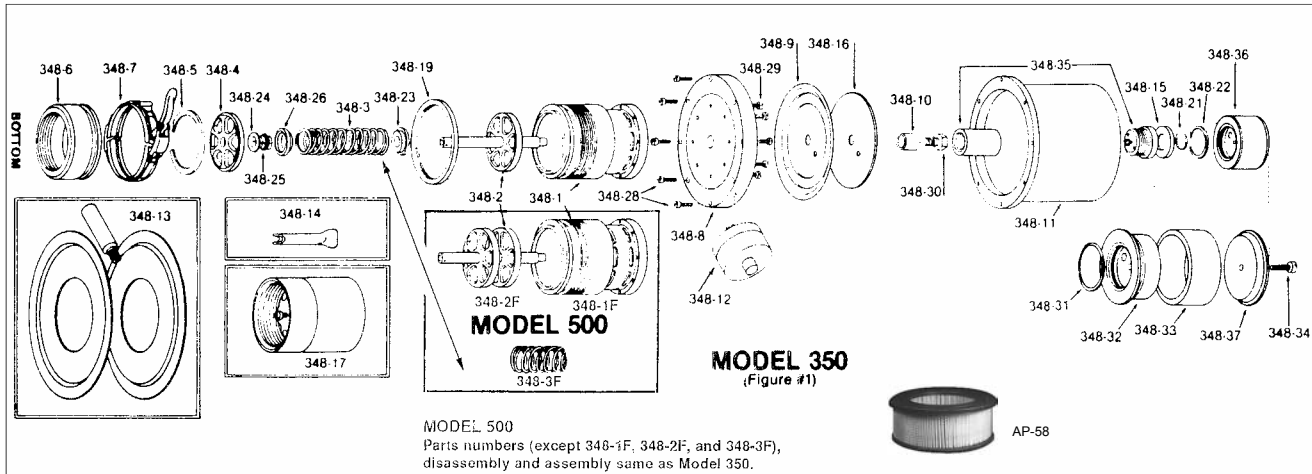

Part#	Part Description
348-01	Body
348-01 F	Body Model 500
348-02	Poppet Assembly
348-02 F	Poppet Assembly Model 500
348-03	Spring Model 350
348-03 F	Spring Model 500
348-04	Poppet Guide
348-05	Large Bottom Snap Ring
348-06	Inlet Adapter
348-07	Quick Disconnect Clamp
348-08	Flange
348-09	Diaphragm Assembly
348-10	Diaphragm Retainer
348-11	Dome
348-12	Air Filter Gauge
348-13	Large Filter Adapter Kit
348-14	S.S. Adjusting Wrench
348-15	Top Felt Filter
348-16	S.S. Back-Up Plate
348-17	Relief Valve (3" NPT fitting)

Part#	Part Description
348-19	Filter Retaining Ring
348-21access	Small Top Snap Ring
348-22	Large Top Snap Ring
348-23	Spring Guide
348-24	Damping Collar Complete
348-25	Damping Collar Spring Only
348-26	Damping Collar Retainer
348-28	Dome Screws (8-32 x 5/8)
348-29	Flange Screws (10-32 x 3/4)
348-30	Diaphragm Bolt
348-31	Top Dome Filter O-Ring
348-32	Filter Cart. Holder-Bottom
348-33	Filter Replacement Cartridge
348-34	Top Filter Holding Screw (10-32 x 3/4)
348-35	Aneroid Assembly Complete
348-35 C	Aneroid Cap Only
348-35 B	Bellows Assembly
348-36	Top Dome Filter Complete
348-37	Filter Cartridge Holder-Top
V-348-51	Poppet Window Band M-500
AP-58	Main Paper Filter
PMM-VC	Parts & Maintenance Manual Model 100/350/500 Vacuum Controllers



**L. J. ENGINEERING, INC.**

18192 Gothard Street, Huntington Beach, CA 92648 USA

Phone: (714) 848-8001 • In USA: 800-635-6413

Fax: (714) 848-0973 Email: info@ljengineering.com

# SENTINEL™ PRODUCTS CATALOG

## SENTINEL PEACEKEEPERS



The Peacekeeper Noise Suppressor & Air Filter is a retro-fittable product for the Sentinel line of vacuum controllers.

The Peacekeeper suppresses the noise created by air flow into the controller and provides a larger washable filter. Testing has shown that the Peacekeeper can cut up to 15 decibels off the existing noise level created by the controllers. Because of excess noise generated by vacuum controllers, performance is often compromised

when units are placed in 'out of the way' locations. The substantially larger size of the filter means a reduction in frequency of filter cleanings, and the filter can be removed for cleaning without disconnecting the Sentinel vacuum controller from the system.

### Key Benefits:

- Reduces noise substantially
- Fits existing Sentinels
- Improves filtration
- Large washable filter

Three units are available: one to fit the Mark II, one for the Model 100 and one that fits both the Model 350 & Model 500.

462-100 fits the Sentinel Model 100

462-200 fits the Sentinel Mark II

462-350 fits the Sentinel Model 350 and Model 500

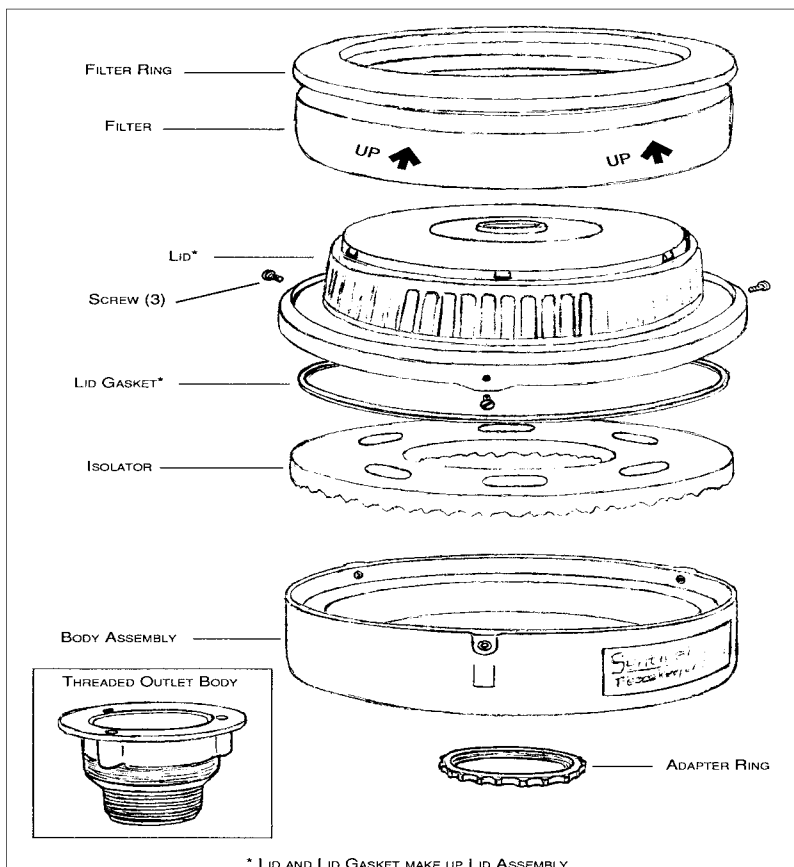

### Sentinel Peacekeeper for the Mark II (462-200)

PARTS FOR MODEL 462-200 PEACEKEEPER FOR SENTINEL MARK II VACUUM CONTROLLERS	
462-1-200	BODY ASSEMBLY
462-2-200	LID ASSEMBLY
462-3	FILTER RING
462-4	FILTER
462-5-200	ISOLATOR
462-6-200	ADAPTER RING
462-8	SCREW
462-14	LID GASKET
406-100	THREADED OUTLET BODY

\* LID AND LID GASKET MAKE UP LID ASSEMBLY

# SENTINEL™ PRODUCTS CATALOG

## Sentinel Peacekeepers for the Model 100, Model 350 and Model 500

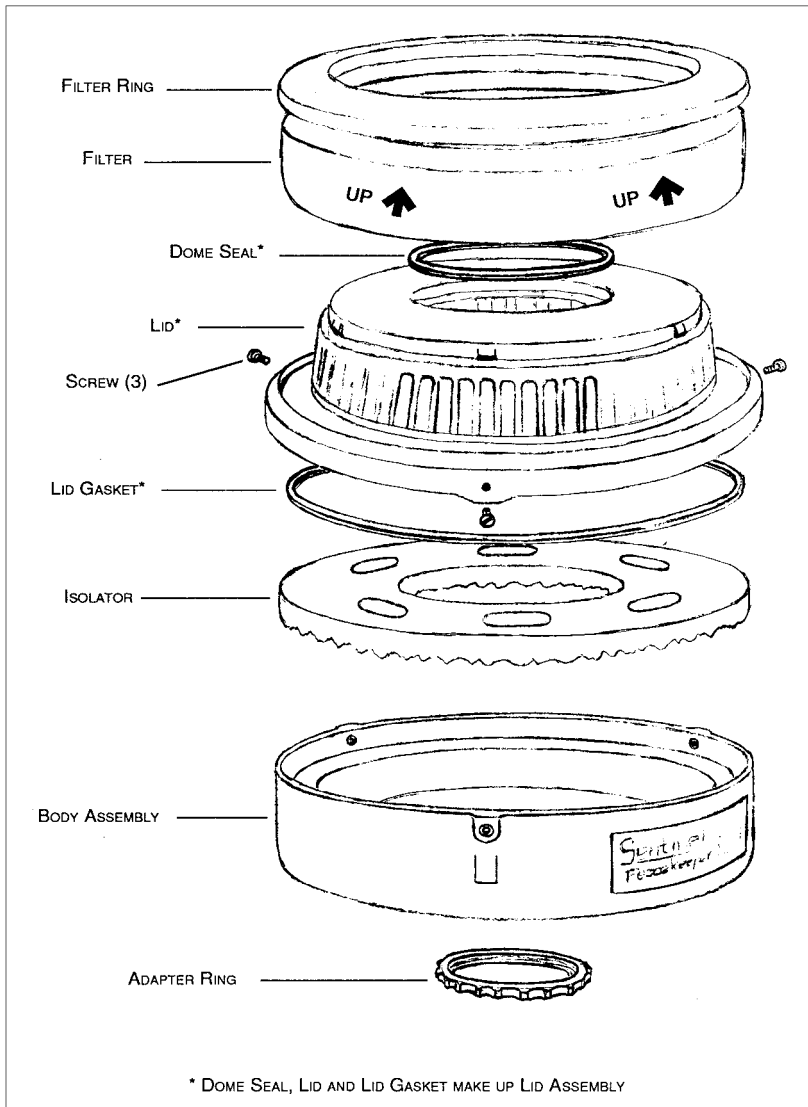

PARTS FOR MODEL 462-100 PEACEKEEPER FOR SENTINEL MODEL 100 VACUUM CONTROLLERS	
462-1-100	BODY ASSEMBLY
462-2-100	LID ASSEMBLY
462-3	FILTER RING
462-4	FILTER
462-5-100	ISOLATOR
462-6-100	ADAPTER RING
462-8	SCREW
462-14	LID GASKET
462-15-100	DOMES SEAL

PARTS FOR MODEL 462-350 PEACEKEEPER FOR SENTINEL MODEL 350/500 VACUUM CONTROLLERS	
462-1-350	BODY ASSEMBLY
462-2-350	LID ASSEMBLY
462-3	FILTER RING
462-4	FILTER
462-5-350	ISOLATOR
348-19	ADAPTER RING
462-8	SCREW
462-14	LID GASKET
462-15-350	DOMES SEAL

# SENTINEL™ PRODUCTS CATALOG

## SENTINEL DIGIMET 3000 – VERSION 4.0

### DESCRIPTION

The *DIGIMET* 3000 is a 5-key, hand-held, battery operated, microprocessor-based vacuum and pulsation multi-function meter for measuring vacuum level characteristics and pulsation attributes in the dairy milking system. Use the *DIGIMET* 3000 to spot-check critical variables within the milking system. With the *DIGIMET* 3000, you can store data and recall it at a later time. The *DIGIMET* 3000's stored data can be either viewed on its LCD screen, uploaded to a computer or printed to the *DIGIMET* Printer. By monitoring vacuum levels, pulsator ratios, milk/rest ratios and pulsation electronics, the *DIGIMET* 3000 can evaluate system performance and improve milking efficiency.

### FEATURES

- 5-key membrane key pad
- 4-row by 16-character LCD
- Accepts pneumatic and electrical input
- User selectable shut-off from 0 to 30 minutes of non-use
- NEW! Display blinks when outside Pulsation Ratio limits
- Battery life of approximately 40 hours
- Microprocessor based, menu-driven software
- Save five 10-second graphs with data collected at 125 Hertz
- Label data with up to 16 characters
- Units measured may be inches of Hg or kPa
- Save data from 30 double coil pulsators
- Serial port output for printer or computer
- DOS & WINDOWS programs included



### DIGIMET 3000 CONFIGURATIONS:

The basic unit will include the *DIGIMET* 3000, user guide, software for computer uploading, a cable to attach to a computer, and miscellaneous fittings, etc. So, if a user has access to a computer, he/she can get a hard copy of the *DIGIMET* data by transferring to the computer and then getting a print-out from the computer's printer. In order to get a printed copy directly from the *DIGIMET* 3000, a *DIGIMET* Printer must be purchased as a separate item.

The following items will be sold as accessories:

*DIGIMET* Printer - This is a 4" x 7" x 3" impact printer which can print characters and graphics. The printer uses voltage from an AC wall transformer which is supplied with the printer.

The Printer uses adding machine roll paper and the printer cartridge is an EPSON HX-20 ribbon.

*Large Hard Carrying Case* - A larger case has been configured to accommodate the *DIGIMET* 3000, accessories, the *DIGIMET* Printer and an AC transformer.

### COMPLETE DIGIMET 3000 PACKAGE:

This package includes the *DIGIMET* 3000, user guide, software for computer uploading, a cable to attach to a computer, miscellaneous fittings, the *DIGIMET* Printer with wall transformer & cables and a Large Carrying Case.

The latest model *DIGIMET* provides unparalleled convenience for measuring vacuum level characteristics and pulsation attributes in the dairy milking system. Spot-check critical variables, store and recall data, upload to a computer, or print to the available *DIGIMET* printer. Our newest unit allows users to **set limits for pulsator ratio parameters**, like a high and low value for the B phase of pulsation. When a user is collecting data with the *Digimet* 3000, **the *Digimet* 3000 display will blink when a parameter value falls outside the desired limits.** This will give guidance to a user as to a potential problem with a pulsator and/or an indication of values that are not appropriate. Existing *Digimet* 3000's are easily modified.

### Digimet 3000 PARTS

329-309	Quick Disconnect Male
471-021	Display assembly
471-052	Banana plugs
471-054	Plug Luer Lock
471-058	Computer Cable
471-059	Needle connector
471-060	Cover 9-pin
471-062	Tubing
471-063	Fabric Case

# SENTINEL™ PRODUCTS CATALOG

## Digimet 3000 PARTS (continued)

471-115	Digimet Printer
471-055	Needle Stainless
471-001UP	Digimet 3000 upgrade
471-056	Plug 1/8-27NPT
471-061	1/8-27NPT-5/32
471-064	T fitting
472-114	Filter

## SENTINEL DIGITAL VACUUM GAUGE



The **Sentinel Digital Vacuum Gauge** Model DVG-1 enables the dairy farmer to monitor the dairy system vacuum accurately to 1/100" Hg. The Sentinel DVG-1 is designed to be installed on the wall of a dairy farm breezeway, so it is water resistant. Compact in size but with 9/16" LED digits, one can view it from many feet away. The DVG-1 is powered with DC voltage from a wall transformer to allow continuous viewing of vacuum levels. **Part number DVG-1.**



## SENTINEL AIR INJECTOR

Use the Sentinel Air Injector Model 465 to fine tune your wash-up system. The Sentinel Air Injector is a time-adjustable, variable air flow air injector.

**Part number AI-465**

## SENTINEL PRODUCTS WEBSTORE

Go online to view our products at:  
[www.sentinelproducts.com](http://www.sentinelproducts.com)



## L. J. ENGINEERING, INC.

18192 Gothard Street, Huntington Beach, CA 92648 USA  
Phone: (714) 848-8001 • In USA: 800-635-6413  
Fax: (714) 848-0973 Email: [info@ljengineering.com](mailto:info@ljengineering.com)

[www.sentinelproducts.com](http://www.sentinelproducts.com)