

SENTINEL™ VACUUM CONTROLLERS – Model 350/500

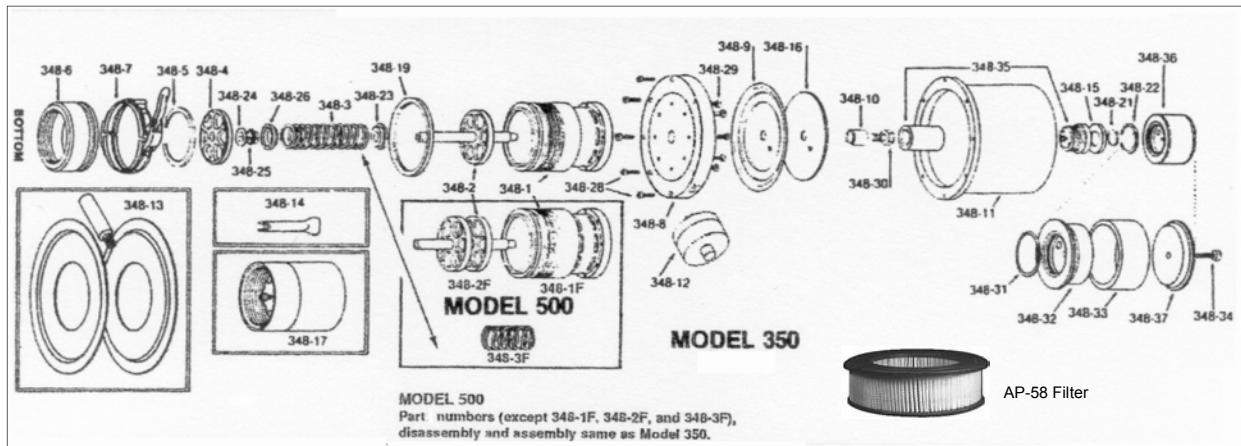

Sentinel Model 350/500 Parts Break-Down

MODEL 350/500 - PARTS	
Part#	Part Description
348-01	Body
348-01 F	Body Model 500
348-02	Poppet Assembly
348-02 F	Poppet Assembly Model 500
348-03	Spring Model 350
348-03 F	Spring Model 500
348-04	Poppet Guide
348-05	Large Bottom Snap Ring
348-06	Inlet Adapter
348-07	Quick Disconnect Clamp
348-08	Flange
348-09	Diaphragm Assembly
348-10	Diaphragm Retainer
348-11	Dome
348-12	Air Filter Gauge
348-13	Large Filter Adapter Kit
348-14	S.S. Adjusting Wrench
348-15	Top Felt Filter
348-16	S.S. Back-Up Plate
348-17	Relief Valve (3" NPT fitting)

Part#	Part Description
348-19	Filter Retaining Ring
348-21	Small Top Snap Ring
348-22	Large Top Snap Ring
348-23	Spring Guide
348-24	Damping Collar Complete
348-25	Damping Collar Spring Only
348-26	Damping Collar Retainer
348-28	Dome Screws (8-32 x 5/8)
348-29	Flange Screws (10-32 x 3/4)
348-30	Diaphragm Bolt
348-31	Top Dome Filter O-Ring
348-32	Filter Cart. Holder-Bottom
348-33	Filter Replacement Cartridge
348-34	Top Filter Holding Screw (10-32 x 3/4)
348-35	Aneroid Assembly Complete
348-35 C	Aneroid Cap Only
348-35 B	Bellows Assembly
348-36	Top Dome Filter Complete
348-37	Filter Cartridge Holder-Top
V-348-51	Poppet Window Band M-500
AP-58	Main Paper Filter
PMM-VC	Parts & Maintenance Manual Model 100/350/500 Vacuum Controllers



L. J. Engineering, Inc.
18192 Gothard Street
Huntington Beach, CA 92648 USA

M350.pdf – 1-21-09

Phone: 714-848-8001
In the USA: 1-800-635-6413
Fax : 714-848-0973

E-mail: mbrazil@sentinelproducts.com
Website: <http://www.sentinelproducts.com>